

Pull Rod for Ninebot S User Manual



The manufacturer reserves the right to make changes to the product and update this manual at any time. Visit www.segway.com to download the latest user materials.

Before using, please read the User Manual carefully and install according to the instructions.

1 Product Overview

Pull rod

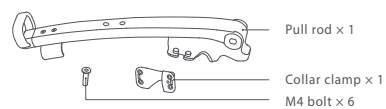

Accessories

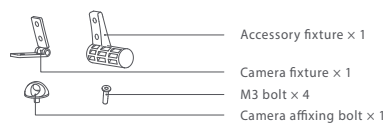

Tools and replacements



2 Pull Rod Installation and Usage

CAUTION:
Before installation and maintenance, please turn off your Ninebot S. When installing the parts, use appropriate torque.

2.1 How to install

*The balancing point may be affected after the rod is installed. Please adjust in the Segway-Ninebot App via: Settings → Sensor → Balance calibration, until the balance is restored.

- Take out the rod and collar clamp from the box.
- Power off the Ninebot S. Install the rod on the steering bar and put the collar clamp in place.

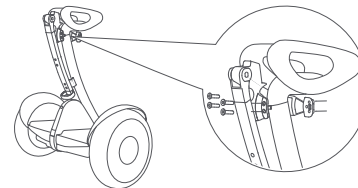
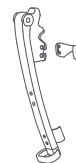

- Tighten the rod and collar clamp with M4 bolts.

2.2 How to use

Flip up the rod and pull the Ninebot S along.

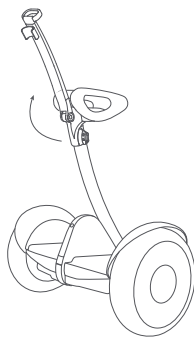

When not in use, fold down the rod and affix on the steering bar.

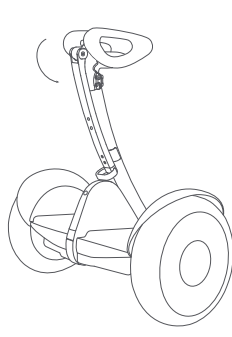

3 Installation of Accessories

Please install the camera fixture and accessory fixture as needed.

Camera fixture

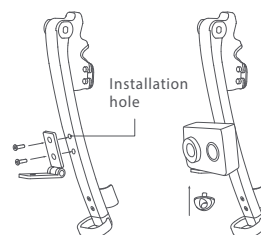

- Use M3 bolts to affix the camera fixture on the pull rod and then tighten the bolts.
- Use the camera affixing bolt to mount your camera.

Accessory fixture

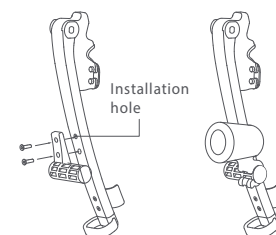

- Use M3 bolts to affix the accessory fixture on the pull rod and then tighten the bolts.
- Mount the headlight onto the fixture.

4 Accessory Replacements

4.1 Handle

Unscrew the bolts on the bottom of the rod. Take off the original handle and replace with the new one, then tighten the bolts.

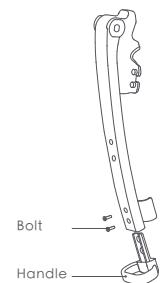

4.2 Camera fixture base

Take off the axle bolt and replace the original base. Tighten the bolt.

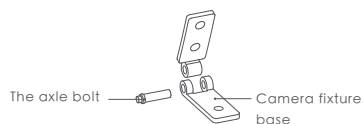

5 Warnings and Cautions

- This product is only applicable to Ninebot S.
- Children should not be allowed to touch or use this product. The product contains detachable parts, which could pose suffocation dangers.
- This product is mainly made of composite materials. Avoid strong external impact. DO NOT use the rod to lift the Ninebot S. DO NOT expose to high temperature for a long time. Keep away from fire.
- To prevent product damage, avoid external forces from hitting or squeezing the rod and the accessories.
- If the product has deformation or looseness, or cannot be installed on the Ninebot S properly, please tighten the bolts or replace the product before continuing to use. Otherwise there may be dangers in driving.

6 Specifications

Model	N3M240-LG	
Size	Length × Width	12.8 × 2.6 in (325 × 65 mm)
Mechanical parameters	Pull rod pulling force (N)	< 130
	Pull rod torque force (N)	< 180
	Camera weight limit (g)	< 100
	Accessory weight limit (g)	< 200

7 After-sales Service

For aftersales service information, please visit our official website.

The Americas: store.segway.com

The Europe: www.segway.com

8 Trademark and Legal Statement

Ninebot is the registered trademark of Ninebot (Tianjin) Tech. Co., Ltd; Segway and the Rider Design are the registered trademarks of Segway Inc.; The respective owners reserve the rights of their trademarks referred to in this manual.

We have attempted to include description and instructions for all the functions of the Pull Rod for Ninebot S at the time of printing. However, due to constant improvement of product features and changes of design, your Pull Rod may differ slightly from the one shown in this document.

©2020 Ninebot (Beijing) Tech Co., Ltd. All rights reserved.